

# PATIENT CARE EXPANSION UPDATE

Less Wait, Less Travel, More Access to Exceptional Healthcare



## November 14, 2025 Update

### Operations

- **Nov 3: Construction starts on 2<sup>nd</sup> floor for new lab space [ground officially “broken”!]**
- All learning/education activities have moved out of Skills Lab
- Library used to store Same-Day South equipment and supplies from Nov 3 to 14; then used for Central Sterile/Surgery equipment and supplies (this door is key coded; Steve Cromer and Anna Engle can provide access)

### Construction & Wayfinding Updates

- **Phase 0 Complete!** Same Day South construction for plumbing, air, and electric work in the ceiling to connect the new 2<sup>nd</sup> floor lab is DONE!
- **Week of Nov 24:** Barriers placed to start construction for new central sterile
  - Nutrition Therapy, Care Coordination, Surgery Storage
  - Alternative route to Med-Surg: hallway to the Right of the main entrance front desk 11/24/25 – 7/31/26

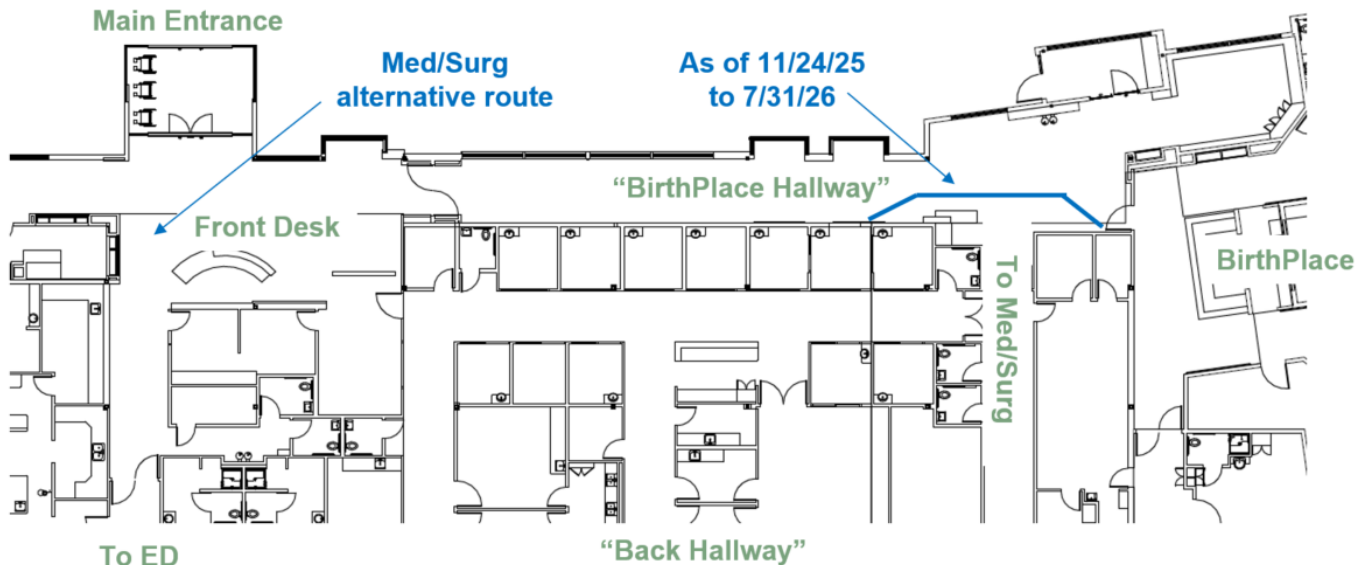

## **Moves Management**

- **Complete**

- Dustene Johnston [Perioperative Services] moved (temporarily) to Corporate Pointe Ste 200
- Anna Engle [Same Day Services], moved into Dustene's office in Same-Day North
- Outpatient Nutrition Therapy will be implementing an integrated model and working out of clinics (Palouse Peds-Pullman, Pullman Family Medicine, Palouse Medical, Residency Center and working out of the former Incyte Diagnostics Suites – near Inland Ortho)
- Care Coordination moved to PAC
- Anna Henderson [Infection Prevention] moved to Corporate Pointe Ste 103
- Cate Carl [Employee Health] moved to Palouse Medical
- Clinical Coordinators moved to Travel Clinic/Security Office in ED

- **This week**

- Inpatient nutrition therapy moving into Jeremy's former office (back hallway)
- RT moving into former Chapel (back hallway)

- **Next week 11/17/25**

- Start moving supplies out of sterile Core & New Central Sterile Space and Equipment Room and into former library

## **Construction Communications**

- Construction Communication Command Center is live in the Safety Huddle hallway (located behind conference rooms)
- Donor Appreciation Ground breaking event 11/12/25; All Staff 11/13/25 Update
- Coffee Ground Rounds, a daily tour highlighting wayfinding changes, will be held after Safety Huddle, starting November 3

## **Parking Reminders**

- Parking reallocation begins November 1 – remember our motto, “Parking = Patient Priority.”
  - Physician Only parking spaces (near the ED) will be reallocated to provide accessible and temporary parking for Physicians and CRNAs
  - Upper East parking lot and cul-de-sac parking (off of Tucannon Court) will be reserved for construction crews, staging and large equipment. Access to the parking lot will be open from Tucannon Court; please do not park in the cul-de-sac.
  - With the exception of ED Patient Parking (which is observed 24/7), please observe the “Patient Only” parking areas, in orange, M-F 6am to 5pm



**Stay in the know:**  
**[pullmanregional.org/internal](https://pullmanregional.org/internal)**

# PULLMAN REGIONAL HOSPITAL CONSTRUCTION PARKING MAP

NOVEMBER 2025

